

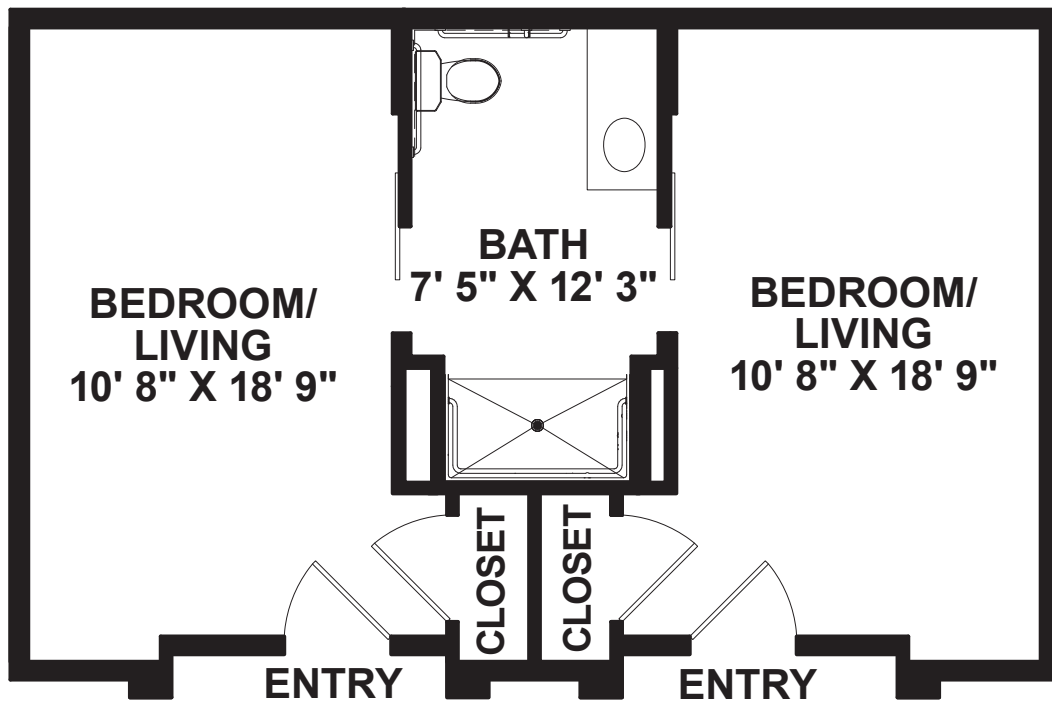

# PRIMROSE | MEMORY CARE

Companion Studio • 270 sq. ft.



APPROXIMATE SQUARE FOOTAGE



# PRIMROSE | MEMORY CARE

Companion Studio • 270 sq. ft.



APPROXIMATE SQUARE FOOTAGE



3281 Long Prairie Road • Flower Mound, Texas 75022 • 469-630-0800  
TheOaksAtFlowerMound.com • ASSISTED LIVING • MEMORY CARE

AL License #106343

